

M54 to M6 Link Road
TR010054
Volume 2
2.8 Traffic Regulation Measures Plans

Regulation 5(2)(o)

Planning Act 2008

Infrastructure Planning (Applications: Prescribed
Forms and Procedure) Regulations 2009

January 2020

Infrastructure Planning

Planning Act 2008

**The Infrastructure Planning
(Applications: Prescribed Forms and
Procedure) Regulations 2009**

**M54 to M6 Link Road
Development Consent Order 202[]**

Traffic Regulation Measures Plans

Regulation Number	Regulation 5(2)(o)
Planning Inspectorate Scheme Reference	TR010054
Application Document Reference	2.8
Author	M54 to M6 Link Road Project Team and Highways England

Version	Date	Status of Version
P01	January 2020	DCO Application

Schedule of Plans included in this Application Document

Drawing Number	Drawing Title	Revision
HE514465-ACM-DCO-M54_SW_PR_Z-DR-CH-1500	TRAFFIC REGULATION MEASURES, REGULATION 5(2)(O) KEY SHEET	P03
HE514465-ACM-DCO-M54_SW_PR_Z-DR-CH-1501	TRAFFIC REGULATION MEASURES, REGULATION 5(2)(O) SHEET 1 OF 10	P02
HE514465-ACM-DCO-M54_SW_PR_Z-DR-CH-1502	TRAFFIC REGULATION MEASURES, REGULATION 5(2)(O) SHEET 2 OF 10	P02
HE514465-ACM-DCO-M54_SW_PR_Z-DR-CH-1503	TRAFFIC REGULATION MEASURES, REGULATION 5(2)(O) SHEET 3 OF 10	P02
HE514465-ACM-DCO-M54_SW_PR_Z-DR-CH-1504	TRAFFIC REGULATION MEASURES, REGULATION 5(2)(O) SHEET 4 OF 10	P03
HE514465-ACM-DCO-M54_SW_PR_Z-DR-CH-1505	TRAFFIC REGULATION MEASURES, REGULATION 5(2)(O) SHEET 5 OF 10	P03
HE514465-ACM-DCO-M54_SW_PR_Z-DR-CH-1506	TRAFFIC REGULATION MEASURES, REGULATION 5(2)(O) SHEET 6 OF 10	P02
HE514465-ACM-DCO-M54_SW_PR_Z-DR-CH-1507	TRAFFIC REGULATION MEASURES, REGULATION 5(2)(O) SHEET 7 OF 10	P02
HE514465-ACM-DCO-M54_SW_PR_Z-DR-CH-1508	TRAFFIC REGULATION MEASURES, REGULATION 5(2)(O) SHEET 8 OF 10	P02
HE514465-ACM-DCO-M54_SW_PR_Z-DR-CH-1509	TRAFFIC REGULATION MEASURES, REGULATION 5(2)(O) SHEET 9 OF 10	P02
HE514465-ACM-DCO-M54_SW_PR_Z-DR-CH-1510	TRAFFIC REGULATION MEASURES, REGULATION 5(2)(O) SHEET 10 OF 10	P02



- NOTES**
1. THIS DRAWING IS TO BE READ IN CONJUNCTION WITH ALL OTHER RELEVANT DOCUMENTATION.
 2. DO NOT SCALE FROM THIS DRAWING. USE ONLY PRINTED DIMENSIONS.
 3. ALL DIMENSIONS IN MILLIMETRES. ALL CHAINAGES, LEVELS AND COORDINATES ARE IN METRES UNLESS DEFINED OTHERWISE.
 4. THIS DRAWING IS TO BE READ IN CONJUNCTION WITH THE PROJECT HEALTH & SAFETY FILE FOR ANY IDENTIFIED POTENTIAL RISKS.
 5. THE WORKS ARE SHOWN ILLUSTRATIVELY ONLY AND ARE SUBJECT TO CHANGE THROUGH DETAILED DESIGN IN ACCORDANCE WITH THE TERMS OF THE DEVELOPMENT CONSENT ORDER.

- KEY**
- LIMITS OF LAND TO BE ACQUIRED OR USED PERMANENTLY OR TEMPORARILY (THE ORDER LIMITS)
 - LAND NOT INCLUDED WITHIN THE ORDER LIMITS

FOR CONTINUATION SEE INSET A

SHEET 1 OF 10
INSET A

FOR CONTINUATION SEE PLAN

INSET A

PLAN

First Issue	MW	RR	06/12/19	P01
Clearways added.	MW	RR	18/12/19	P02
Minor amendments.	MW	RR	21/01/20	P03
Revision Details	By	Check	Date	Suffix

Purpose of issue
DCO APPLICATION

Client
Highways England
Floor 5
Two Colmore Square
38 Colmore Circus
Birmingham
B4 6BN



Development Consent Order Number
TR010054

Project Title
M54 to M6 Link Road

Development Consent Order Drawing Number
TR010054/APP/2.8

Drawing Title
TRAFFIC REGULATION MEASURES, REGULATION 5(2)(O) KEY SHEET

Designed	MW	Drawn	AM	Checked	RR	Approved	RR	Date	21/01/20
Internal Project No.	60536736		Suitability	S8					
Scale @ A1	1:20000H/1:20000V		Zone	Development Consent Order					

THIS DOCUMENT HAS BEEN PREPARED PURSUANT TO AND SUBJECT TO THE TERMS OF AECOM'S APPOINTMENT BY ITS CLIENT. AECOM ACCEPTS NO LIABILITY FOR ANY USE OF THIS DOCUMENT OTHER THAN BY ITS ORIGINAL CLIENT OR FOLLOWING AECOM'S EXPRESS AGREEMENT TO SUCH USE, AND ONLY FOR THE PURPOSES FOR WHICH IT WAS PREPARED AND PROVIDED.

Drawing Number	Highways England PIN	1 Originator	1 Volume	Rev
HE514465	-ACM	-DCO	-DR-CH-1500	P03
M54_SW_PR_Z				
Location	1 Type	1 Role	1 Number	

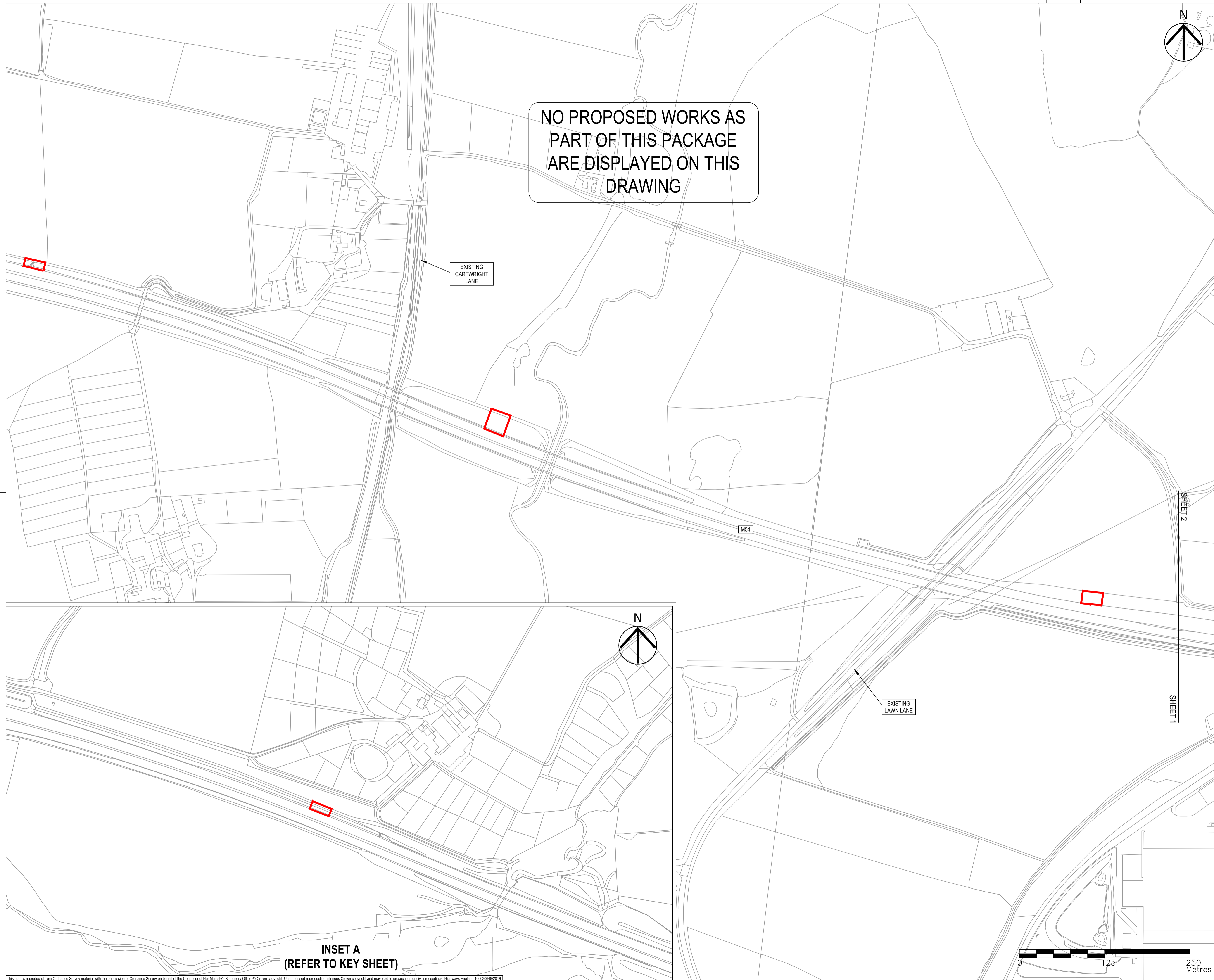

NO PROPOSED WORKS AS PART OF THIS PACKAGE ARE DISPLAYED ON THIS DRAWING

EXISTING CARTWRIGHT LANE

EXISTING LAWN LANE

M54

SHEET 2

SHEET 1

INSET A
(REFER TO KEY SHEET)

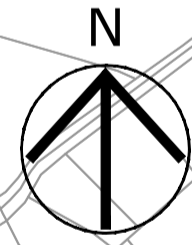
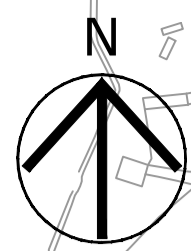

- NOTES
1. THIS DRAWING IS TO BE READ IN CONJUNCTION WITH ALL OTHER RELEVANT DOCUMENTATION.
 2. DO NOT SCALE FROM THIS DRAWING, USE ONLY PRINTED DIMENSIONS.
 3. ALL DIMENSIONS IN MILLIMETRES, ALL CHAINAGES, LEVELS AND COORDINATES ARE IN METRES UNLESS DEFINED OTHERWISE.
 4. THIS DRAWING IS TO BE READ IN CONJUNCTION WITH THE PROJECT HEALTH & SAFETY FILE FOR ANY IDENTIFIED POTENTIAL RISKS.
 5. THE WORKS ARE SHOWN ILLUSTRATIVELY ONLY AND ARE SUBJECT TO CHANGE THROUGH DETAILED DESIGN IN ACCORDANCE WITH THE TERMS OF THE DEVELOPMENT CONSENT ORDER.

- KEY
- LIMITS OF LAND TO BE ACQUIRED OR USED PERMANENTLY OR TEMPORARILY (THE ORDER LIMITS)
 - LAND NOT INCLUDED WITHIN THE ORDER LIMITS
 - PROPOSED 30mph SPEED LIMIT
 - PROPOSED 40mph SPEED LIMIT
 - PROPOSED 50mph SPEED LIMIT
 - PROPOSED NATIONAL SPEED LIMIT
 - PROPOSED SPECIAL ROAD SPEED LIMIT
 - × × PROPOSED CLEARWAY
 - PROPOSED PROHIBITION OF ENTRY
 - PROPOSED NO THROUGH ROAD
 - EXISTING NO RIGHT TURN
 - PROPOSED STRUCTURE

First Issue	MW	RR	06/12/19	P01
Clearways added.	MW	RR	18/12/19	P02
	By	Check	Date	Suffix

Purpose of issue
DCO APPLICATION

Client
Highways England
Floor 5
Two Colonnade Square
38 Colonnade Circus
Birmingham
B4 6BN



Development Consent Order Number
TR010054

Project Title
M54 to M6 Link Road

Development Consent Order Drawing Number
TR010054/APP/2.8

Drawing Title
TRAFFIC REGULATION MEASURES, REGULATION 5(2)(O) SHEET 1 OF 10

Designed	Drawn	Checked	Approved	Date
MW	AM	AM	RR	18/12/19
Internal Project No. 60536736				Suitability S8
Scale @ A1 1:2500H/1:2500V				Zone Development Consent Order

THIS DOCUMENT HAS BEEN PREPARED PURSUANT TO AND SUBJECT TO THE TERMS OF AECOM'S APPOINTMENT BY ITS CLIENT. AECOM ACCEPTS NO LIABILITY FOR ANY USE OF THIS DOCUMENT OTHER THAN BY ITS ORIGINAL CLIENT OR FOLLOWING AECOM'S EXPRESS AGREEMENT TO SUCH USE, AND ONLY FOR THE PURPOSES FOR WHICH IT WAS PREPARED AND PROVIDED.

Drawing Number	Highways England PIN	I Originator	I Volume	Rev
HE514465	-ACM	-DCO-		P02
Z1_SW_PR_Z		-DR-CH-1501		
Location	I Type	I Role	I Number	

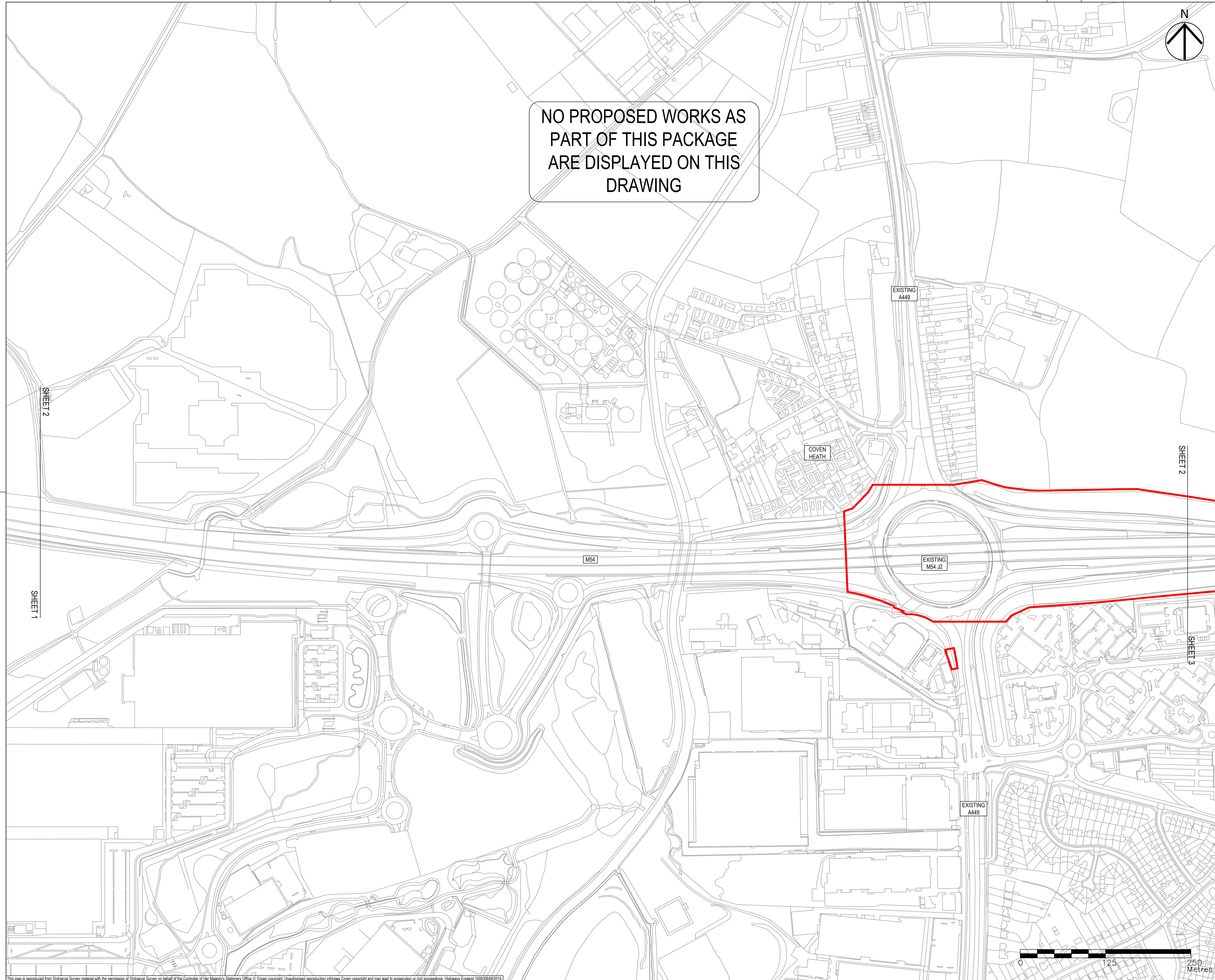

NO PROPOSED WORKS AS PART OF THIS PACKAGE ARE DISPLAYED ON THIS DRAWING

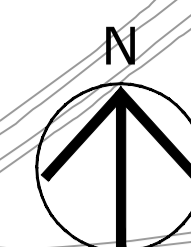

- NOTES**
1. THIS DRAWING IS TO BE READ IN CONJUNCTION WITH ALL OTHER RELEVANT DOCUMENTATION.
 2. DO NOT SCALE FROM THIS DRAWING. USE ONLY PRINTED DIMENSIONS.
 3. ALL DIMENSIONS IN MILLIMETRES. ALL CHAINAGES, LEVELS AND COORDINATES ARE IN METRES UNLESS DEFINED OTHERWISE.
 4. THIS DRAWING IS TO BE READ IN CONJUNCTION WITH THE PROJECT HEALTH & SAFETY FILE FOR ANY IDENTIFIED POTENTIAL RISKS.
 5. THE WORKS ARE SHOWN ILLUSTRATIVELY ONLY AND ARE SUBJECT TO CHANGE THROUGH DETAILED DESIGN IN ACCORDANCE WITH THE TERMS OF THE DEVELOPMENT CONSENT ORDER.

- KEY**
- LIMITS OF LAND TO BE ACQUIRED OR USED PERMANENTLY OR TEMPORARILY (THE ORDER LIMITS)
 - LAND NOT INCLUDED WITHIN THE ORDER LIMITS
 - PROPOSED 30mph SPEED LIMIT
 - PROPOSED 40mph SPEED LIMIT
 - PROPOSED 50mph SPEED LIMIT
 - PROPOSED NATIONAL SPEED LIMIT
 - PROPOSED SPECIAL ROAD SPEED LIMIT
 - × × PROPOSED CLEARWAY
 - PROPOSED PROHIBITION OF ENTRY
 - PROPOSED NO THROUGH ROAD
 - EXISTING NO RIGHT TURN
 - PROPOSED STRUCTURE

First Issue	MW	RR	06/12/19	P01
Clearways added.	MW	RR	18/12/19	P02
	By	Check	Date	Suffix

DCO APPLICATION

Client
Highways England
Floor 5
Two Colonnade Square
38 Colonnade Circus
Birmingham
B4 6BN



Development Consent Order Number
TR010054

Project Title
M54 to M6 Link Road

Development Consent Order Drawing Number
TR010054/APP/2.8

TRAFFIC REGULATION MEASURES, REGULATION 5(2)(O) SHEET 2 OF 10

Designed	Drawn	Checked	Approved	Date
MW	MW	AM	RR	18/12/19
Internal Project No. 60536736			Suitability S8	
Scale @ A1 1:2500H/1:2500V			Zone Development Consent Order	

THIS DOCUMENT HAS BEEN PREPARED PURSUANT TO AND SUBJECT TO THE TERMS OF AECOM'S APPOINTMENT BY ITS CLIENT. AECOM ACCEPTS NO LIABILITY FOR ANY USE OF THIS DOCUMENT OTHER THAN BY ITS ORIGINAL CLIENT OR FOLLOWING AECOM'S EXPRESS AGREEMENT TO SUCH USE, AND ONLY FOR THE PURPOSES FOR WHICH IT WAS PREPARED AND PROVIDED.

Drawing Number HE514465 -ACM	I Originator -DCO-	I Volume Z1_SW_PR_Z	I Type -DR-CH-1502	I Role P02
---------------------------------	-----------------------	------------------------	-----------------------	---------------



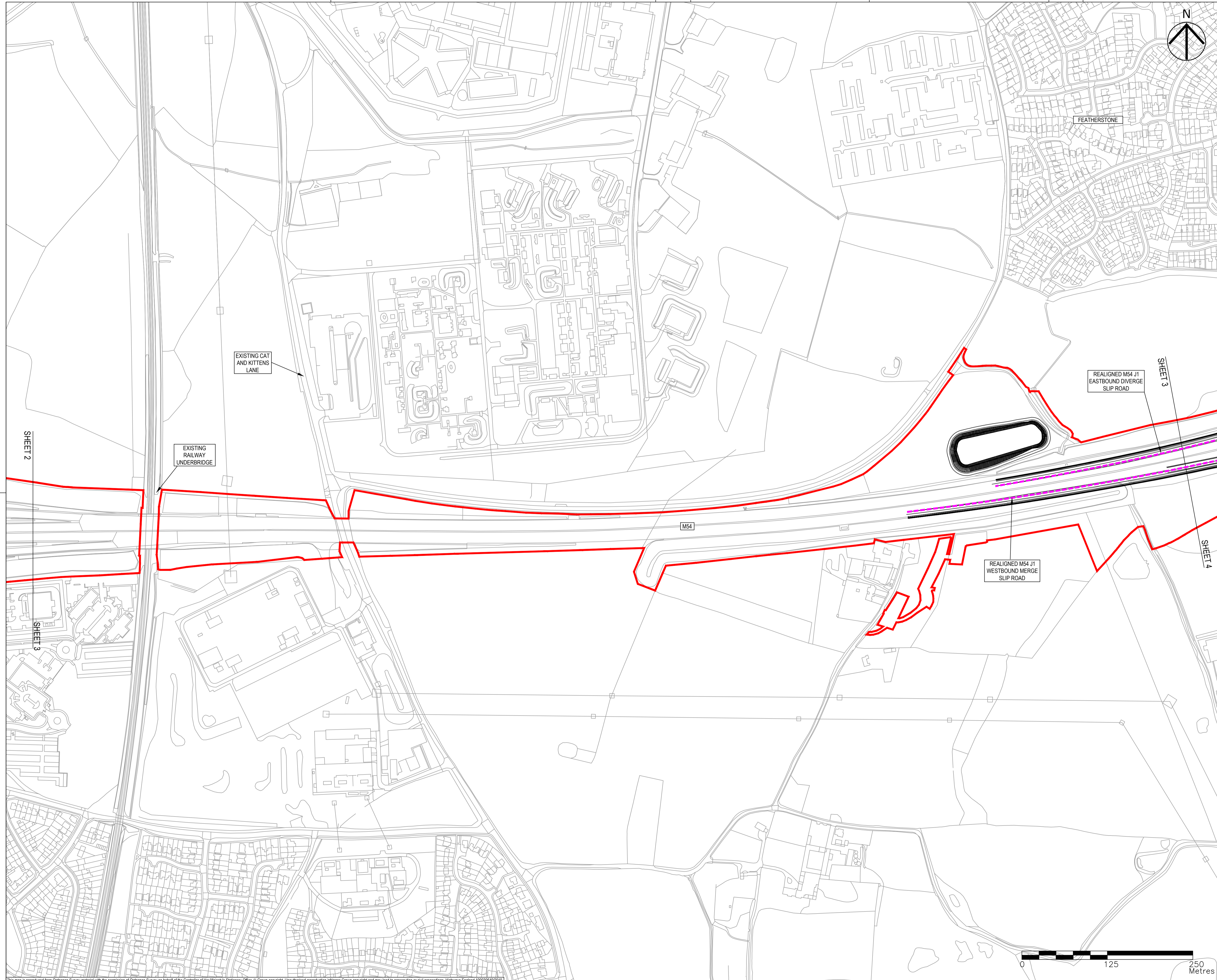

- NOTES**
1. THIS DRAWING IS TO BE READ IN CONJUNCTION WITH ALL OTHER RELEVANT DOCUMENTATION.
 2. DO NOT SCALE FROM THIS DRAWING. USE ONLY PRINTED DIMENSIONS.
 3. ALL DIMENSIONS IN MILLIMETRES. ALL CHAINAGES, LEVELS AND COORDINATES ARE IN METRES UNLESS DEFINED OTHERWISE.
 4. THIS DRAWING IS TO BE READ IN CONJUNCTION WITH THE PROJECT HEALTH & SAFETY FILE FOR ANY IDENTIFIED POTENTIAL RISKS.
 5. THE WORKS ARE SHOWN ILLUSTRATIVELY ONLY AND ARE SUBJECT TO CHANGE THROUGH DETAILED DESIGN IN ACCORDANCE WITH THE TERMS OF THE DEVELOPMENT CONSENT ORDER.

- KEY**
- LIMITS OF LAND TO BE ACQUIRED OR USED PERMANENTLY OR TEMPORARILY (THE ORDER LIMITS)
 - LAND NOT INCLUDED WITHIN THE ORDER LIMITS
 - PROPOSED 30mph SPEED LIMIT
 - PROPOSED 40mph SPEED LIMIT
 - PROPOSED 50mph SPEED LIMIT
 - PROPOSED NATIONAL SPEED LIMIT
 - PROPOSED SPECIAL ROAD SPEED LIMIT
 - × × PROPOSED CLEARWAY
 - ⊘ PROPOSED PROHIBITION OF ENTRY
 - ⊞ PROPOSED NO THROUGH ROAD
 - ⊘ EXISTING NO RIGHT TURN
 - PROPOSED STRUCTURE

EXISTING CAT AND KITTENS LANE

EXISTING RAILWAY UNDERBRIDGE

REALIGNED M54 J1 EASTBOUND DIVERGE SLIP ROAD

REALIGNED M54 J1 WESTBOUND MERGE SLIP ROAD

M54

SHEET 2

SHEET 3

SHEET 3

SHEET 4

First Issue	MW	RR	06/12/19	P01
Clearways added	MW	RR	18/12/19	P02
Revision Details	By	Check	Date	Suffix

Purpose of issue
DCO APPLICATION

Client
Highways England
Floor 5
Two Colmore Square
38 Colmore Circus
Birmingham
B4 6BN



Development Consent Order Number
TR010054

Project Title
M54 to M6 Link Road

Development Consent Order Drawing Number
TR010054/APP/2.8

Drawing Title
TRAFFIC REGULATION MEASURES, REGULATION 5(2)(O) SHEET 3 OF 10

Designed	Drawn	Checked	Approved	Date
MW	MW	AM	RR	18/12/19
Internal Project No.	Suitability			
60536736	S8			
Scale @ A1	Zone			
1:2500H/1:2500V	Development Consent Order			

THIS DOCUMENT HAS BEEN PREPARED PURSUANT TO AND SUBJECT TO THE TERMS OF AECOM'S APPOINTMENT BY ITS CLIENT. AECOM ACCEPTS NO LIABILITY FOR ANY USE OF THIS DOCUMENT OTHER THAN BY ITS ORIGINAL CLIENT OR FOLLOWING AECOM'S EXPRESS AGREEMENT TO SUCH USE, AND ONLY FOR THE PURPOSES FOR WHICH IT WAS PREPARED AND PROVIDED.

Drawing Number	Highways England PIN	I Originator	I Volume	Rev
HE514465	-ACM	-DCO-		P02
Z1_SW_PR_Z		-DR-CH-1503		
Location	I Type	I Role	I Number	

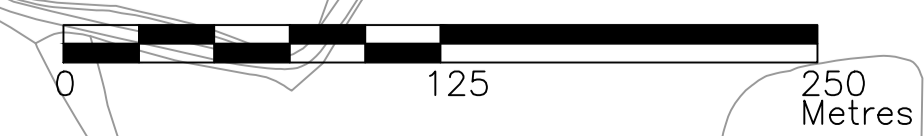

This map is reproduced from Ordnance Survey material with the permission of Ordnance Survey on behalf of the Controller of Her Majesty's Stationery Office. © Crown copyright. Unauthorised reproduction infringes Crown copyright and may lead to prosecution or civil proceedings. Highways England 100030649(2019)

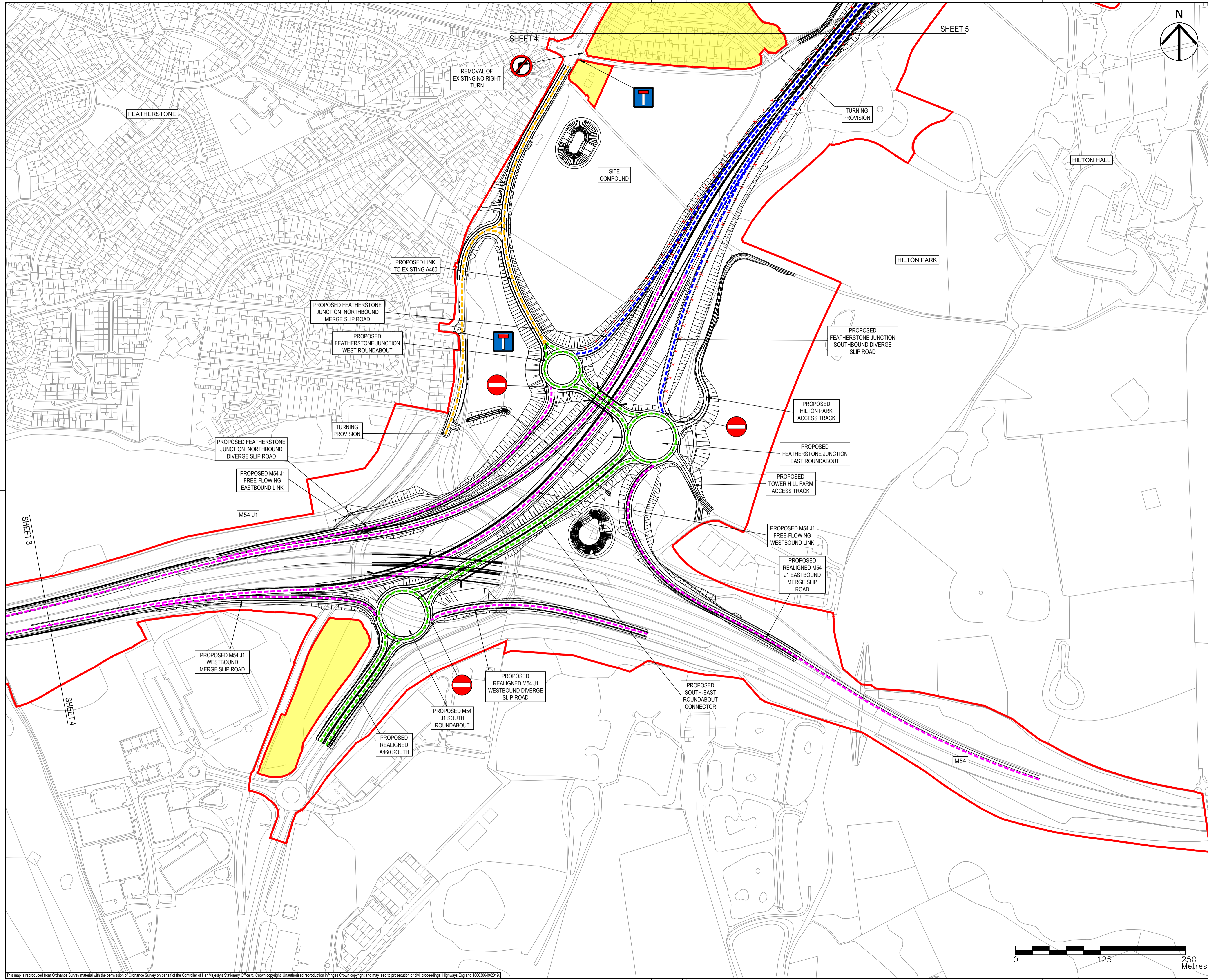

- NOTES
- THIS DRAWING IS TO BE READ IN CONJUNCTION WITH ALL OTHER RELEVANT DOCUMENTATION.
 - DO NOT SCALE FROM THIS DRAWING. USE ONLY PRINTED DIMENSIONS.
 - ALL DIMENSIONS IN MILLIMETRES. ALL CHAINAGES, LEVELS AND COORDINATES ARE IN METRES UNLESS DEFINED OTHERWISE.
 - THIS DRAWING IS TO BE READ IN CONJUNCTION WITH THE PROJECT HEALTH & SAFETY FILE FOR ANY IDENTIFIED POTENTIAL RISKS.
 - THE WORKS ARE SHOWN ILLUSTRATIVELY ONLY AND ARE SUBJECT TO CHANGE THROUGH DETAILED DESIGN IN ACCORDANCE WITH THE TERMS OF THE DEVELOPMENT CONSENT ORDER.

- KEY
- LIMITS OF LAND TO BE ACQUIRED OR USED PERMANENTLY OR TEMPORARILY (THE ORDER LIMITS)
 - LAND NOT INCLUDED WITHIN THE ORDER LIMITS
 - PROPOSED 30mph SPEED LIMIT
 - PROPOSED 40mph SPEED LIMIT
 - PROPOSED 50mph SPEED LIMIT
 - PROPOSED NATIONAL SPEED LIMIT
 - PROPOSED SPECIAL ROAD SPEED LIMIT
 - PROPOSED CLEARWAY
 - PROPOSED PROHIBITION OF ENTRY
 - PROPOSED NO THROUGH ROAD
 - EXISTING NO RIGHT TURN
 - PROPOSED STRUCTURE

First Issue	MW	RR	06/12/19	P01
Clearways added	MW	RR	18/12/19	P02
Minor amendments	MW	RR	21/01/20	P03
Revision Details	By	RR	Date	Suffix
	Check			

Purpose of Issue
DCO APPLICATION

Client
Highways England
Floor 5
Two Colmore Square
38 Colmore Circus
Birmingham
B4 6BN

Development Consent Order Number
TR010054

Project Title
M54 to M6 Link Road

Development Consent Order Drawing Number
TR010054/APP/2.8

Drawing Title
TRAFFIC REGULATION MEASURES, REGULATION 5(2)(O) SHEET 4 OF 10

Designed MW	Draw MW	Checked AM	Approved RR	Date
60536736				21/01/20
Internal Project No.	Suitability			
1:2500H/1:2500V	S8			
Scale @ A1	Zone			
	Development Consent Order			

THIS DOCUMENT HAS BEEN PREPARED PURSUANT TO AND SUBJECT TO THE TERMS OF AECOM'S APPOINTMENT BY ITS CLIENT. AECOM ACCEPTS NO LIABILITY FOR ANY USE OF THIS DOCUMENT OTHER THAN BY ITS ORIGINAL CLIENT OR FOLLOWING AECOM'S EXPRESS AGREEMENT TO SUCH USE, AND ONLY FOR THE PURPOSES FOR WHICH IT WAS PREPARED AND PROVIDED.

Drawing Number	Highways England PIN	I Originator	I Volume	Rev
HE514465	-ACM	-DCO-		P03
Z1_SW_PR_Z		-DR-CH-1504		
Location	I Type	I Role	I Number	

This map is reproduced from Ordnance Survey material with the permission of Ordnance Survey on behalf of the Controller of Her Majesty's Stationery Office © Crown copyright. Unauthorised reproduction infringes Crown copyright and may lead to prosecution or civil proceedings. Highways England 100030649(2019)

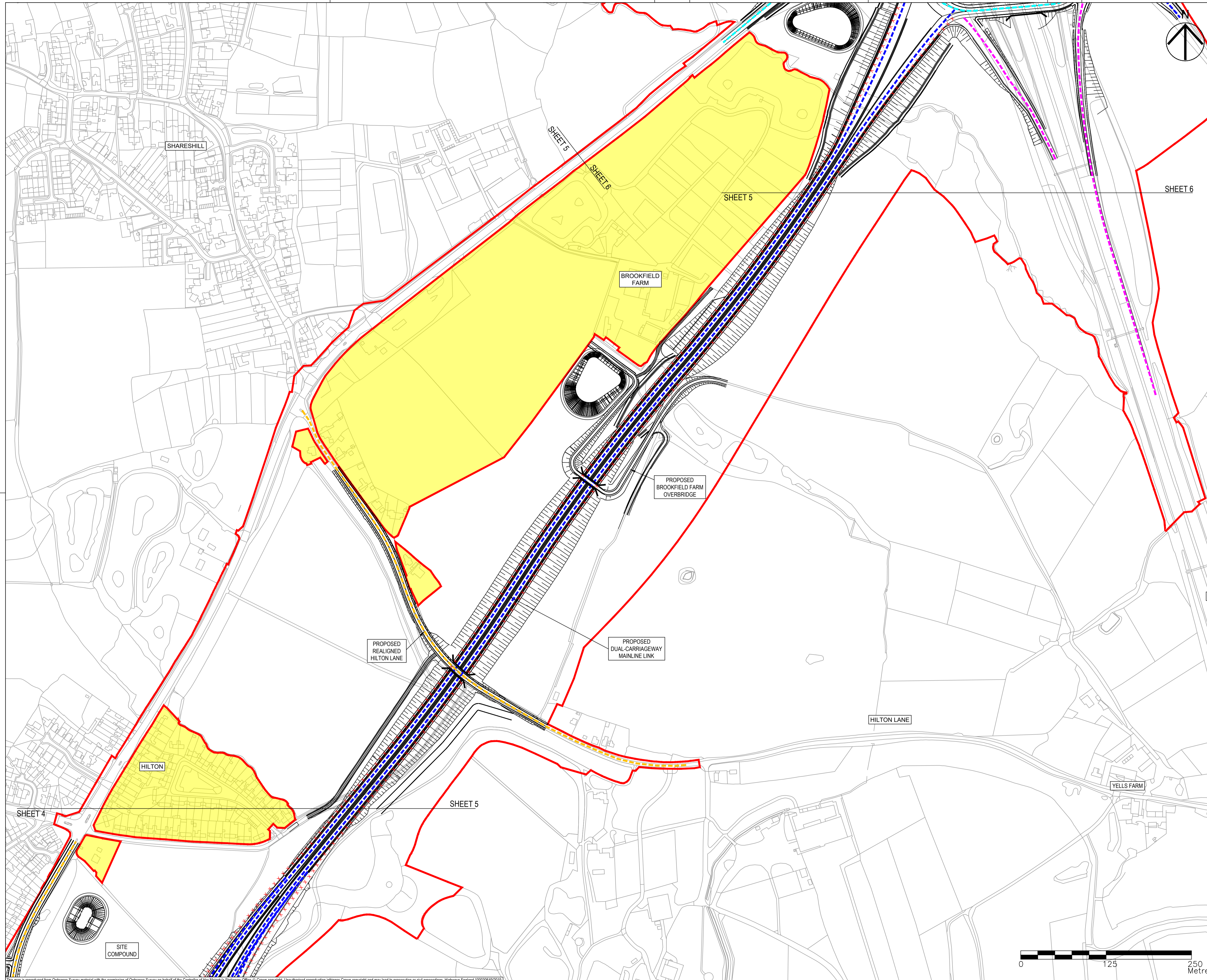

- NOTES**
1. THIS DRAWING IS TO BE READ IN CONJUNCTION WITH ALL OTHER RELEVANT DOCUMENTATION.
 2. DO NOT SCALE FROM THIS DRAWING. USE ONLY PRINTED DIMENSIONS.
 3. ALL DIMENSIONS IN MILLIMETRES. ALL CHAINAGES, LEVELS AND COORDINATES ARE IN METRES UNLESS DEFINED OTHERWISE.
 4. THIS DRAWING IS TO BE READ IN CONJUNCTION WITH THE PROJECT HEALTH & SAFETY FILE FOR ANY IDENTIFIED POTENTIAL RISKS.
 5. THE WORKS ARE SHOWN ILLUSTRATIVELY ONLY AND ARE SUBJECT TO CHANGE THROUGH DETAILED DESIGN IN ACCORDANCE WITH THE TERMS OF THE DEVELOPMENT CONSENT ORDER.

- KEY**
- LIMITS OF LAND TO BE ACQUIRED OR USED PERMANENTLY OR TEMPORARILY (THE ORDER LIMITS)
 - LAND NOT INCLUDED WITHIN THE ORDER LIMITS
 - PROPOSED 30mph SPEED LIMIT
 - PROPOSED 40mph SPEED LIMIT
 - PROPOSED 50mph SPEED LIMIT
 - PROPOSED NATIONAL SPEED LIMIT
 - PROPOSED SPECIAL ROAD SPEED LIMIT
 - × × PROPOSED CLEARWAY
 - PROPOSED PROHIBITION OF ENTRY
 - PROPOSED NO THROUGH ROAD
 - EXISTING NO RIGHT TURN
 - PROPOSED STRUCTURE

Revision Details	By	Check	Date	Suffix
First Issue	MW	RR	06/12/19	P01
Clearways added.	MW	RR	18/12/19	P02
Minor amendments.	MW	RR	21/01/20	P03

DCO APPLICATION

Client
 Highways England
 Floor 5
 20 Colmore Square
 20 Colmore Circus
 Birmingham
 B4 6BN

Development Consent Order Number
TR010054

Project Title
M54 to M6 Link Road

Development Consent Order Drawing Number
TR010054/APP/2.8

Drawing Title
TRAFFIC REGULATION MEASURES, REGULATION 5(2)(O) SHEET 5 OF 10

Designed	Drawn	Checked	Approved	Date
MW	MW	AM	RR	21/01/20

Internal Project No. 60536736
 Substation S8
 Scale @ A1 1:2500H/1:2500V
 Zone Development Consent Order

THIS DOCUMENT HAS BEEN PREPARED PURSUANT TO AND SUBJECT TO THE TERMS OF AECOM'S APPOINTMENT BY ITS CLIENT. AECOM ACCEPTS NO LIABILITY FOR ANY USE OF THIS DOCUMENT OTHER THAN BY ITS ORIGINAL CLIENT OR FOLLOWING AECOM'S EXPRESS AGREEMENT TO SUCH USE, AND ONLY FOR THE PURPOSES FOR WHICH IT WAS PREPARED AND PROVIDED.

Drawing Number	Highways England PIN	I Originator	I Volume	Rev
HE514465	-ACM	-DCO-		P03
Z2_SW_PR_Z		-DR-CH-1505		
Location	I Type	I Role	I Number	

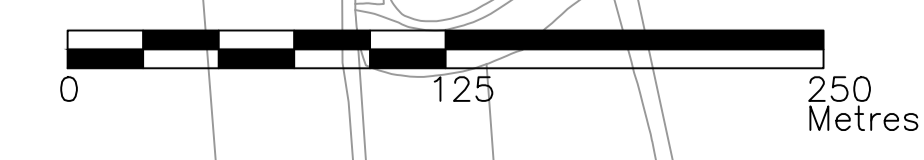

This map is reproduced from Ordnance Survey material with the permission of Ordnance Survey on behalf of the Controller of Her Majesty's Stationary Office © Crown copyright. Unauthorised reproduction infringes Crown copyright and may lead to prosecution or civil proceedings. Highways England 100030649(2019)

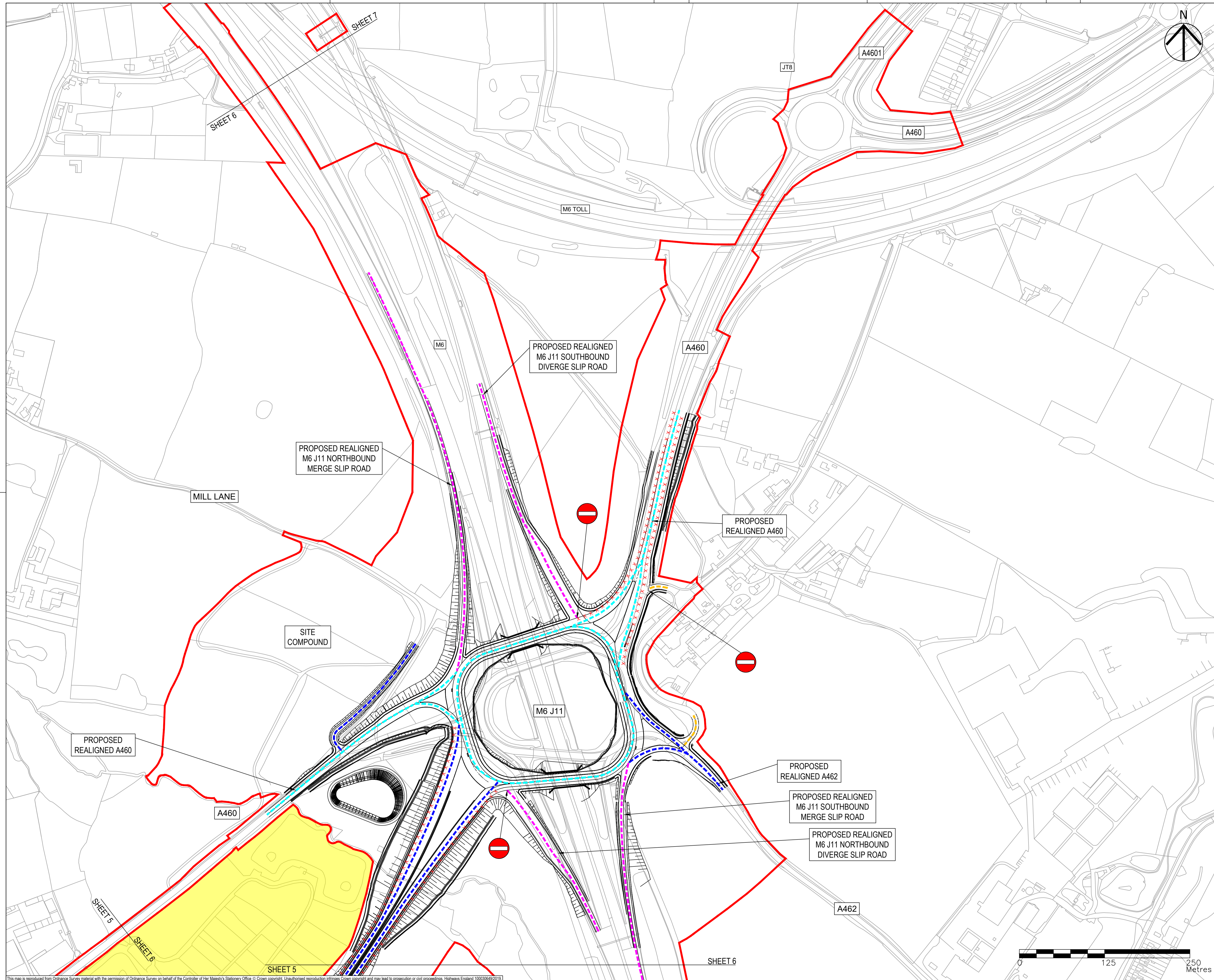

- NOTES**
1. THIS DRAWING IS TO BE READ IN CONJUNCTION WITH ALL OTHER RELEVANT DOCUMENTATION.
 2. DO NOT SCALE FROM THIS DRAWING. USE ONLY PRINTED DIMENSIONS.
 3. ALL DIMENSIONS IN MILLIMETRES. ALL CHAINAGES, LEVELS AND COORDINATES ARE IN METRES UNLESS DEFINED OTHERWISE.
 4. THIS DRAWING IS TO BE READ IN CONJUNCTION WITH THE PROJECT HEALTH & SAFETY FILE FOR ANY IDENTIFIED POTENTIAL RISKS.
 5. THE WORKS ARE SHOWN ILLUSTRATIVELY ONLY AND ARE SUBJECT TO CHANGE THROUGH DETAILED DESIGN IN ACCORDANCE WITH THE TERMS OF THE DEVELOPMENT CONSENT ORDER.

- KEY**
- LIMITS OF LAND TO BE ACQUIRED OR USED PERMANENTLY OR TEMPORARILY (THE ORDER LIMITS)
 - LAND NOT INCLUDED WITHIN THE ORDER LIMITS
 - PROPOSED 30mph SPEED LIMIT
 - PROPOSED 40mph SPEED LIMIT
 - PROPOSED 50mph SPEED LIMIT
 - PROPOSED NATIONAL SPEED LIMIT
 - PROPOSED SPECIAL ROAD SPEED LIMIT
 - × × PROPOSED CLEARWAY
 - ⊘ PROPOSED PROHIBITION OF ENTRY
 - ⊘ PROPOSED NO THROUGH ROAD
 - ⊘ EXISTING NO RIGHT TURN
 - PROPOSED STRUCTURE

First Issue	MW	RR	06/12/19	P01
Clearways added.	MW	RR	18/12/19	P02
Revision Details	By	Check	Date	Suffix

Purpose of issue
DCO APPLICATION

Client
Highways England
Floor 5
Two Colonnade Square
38 Colonnade Circus
Birmingham
B4 6BN



Development Consent Order Number
TR010054

Project Title
M54 to M6 Link Road

Development Consent Order Drawing Number
TR010054/APP/2.8

Drawing Title
TRAFFIC REGULATION MEASURES, REGULATION 5(2)(O) SHEET 6 OF 10

Designed	MW	AM	Checked	RR	Approved	RR	Date	18/12/19
Internal Project No.	60536736		Suitability		S8			
Scale @ A1	1:2500H/1:2500V		Zone		Development Consent Order			

THIS DOCUMENT HAS BEEN PREPARED PURSUANT TO AND SUBJECT TO THE TERMS OF AECOM'S APPOINTMENT BY ITS CLIENT. AECOM ACCEPTS NO LIABILITY FOR ANY USE OF THIS DOCUMENT OTHER THAN BY ITS ORIGINAL CLIENT OR FOLLOWING AECOM'S EXPRESS AGREEMENT TO SUCH USE, AND ONLY FOR THE PURPOSES FOR WHICH IT WAS PREPARED AND PROVIDED.

Drawing Number	HE514465	Originator	-ACM-	Volume	-DCO-	Rev	P02
Location	Z3 SW_PR_Z	I Type	-DR-	I Role	CH-1506		



This map is reproduced from Ordnance Survey material with the permission of Ordnance Survey on behalf of the Controller of Her Majesty's Stationery Office. © Crown copyright. Unauthorised reproduction infringes Crown copyright and may lead to prosecution or civil proceedings. Highways England 100030549(2019)

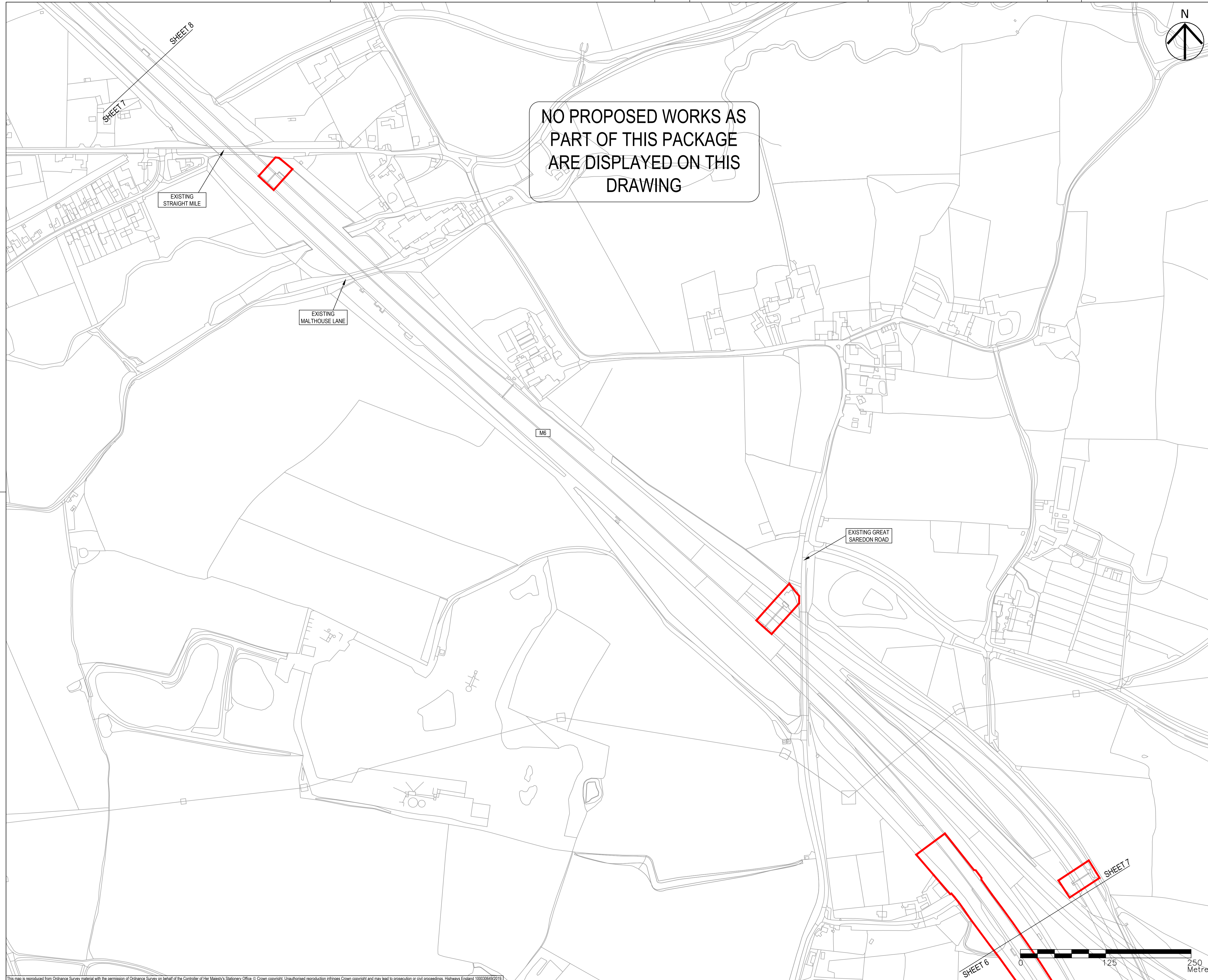

NO PROPOSED WORKS AS PART OF THIS PACKAGE ARE DISPLAYED ON THIS DRAWING

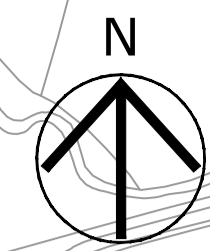

- NOTES
1. THIS DRAWING IS TO BE READ IN CONJUNCTION WITH ALL OTHER RELEVANT DOCUMENTATION.
 2. DO NOT SCALE FROM THIS DRAWING. USE ONLY PRINTED DIMENSIONS.
 3. ALL DIMENSIONS IN MILLIMETRES. ALL CHAINAGES, LEVELS AND COORDINATES ARE IN METRES UNLESS DEFINED OTHERWISE.
 4. THIS DRAWING IS TO BE READ IN CONJUNCTION WITH THE PROJECT HEALTH & SAFETY FILE FOR ANY IDENTIFIED POTENTIAL RISKS.
 5. THE WORKS ARE SHOWN ILLUSTRATIVELY ONLY AND ARE SUBJECT TO CHANGE THROUGH DETAILED DESIGN IN ACCORDANCE WITH THE TERMS OF THE DEVELOPMENT CONSENT ORDER.

- KEY
- LIMITS OF LAND TO BE ACQUIRED OR USED PERMANENTLY OR TEMPORARILY (THE ORDER LIMITS)
 - LAND NOT INCLUDED WITHIN THE ORDER LIMITS
 - PROPOSED 30mph SPEED LIMIT
 - PROPOSED 40mph SPEED LIMIT
 - PROPOSED 50mph SPEED LIMIT
 - PROPOSED NATIONAL SPEED LIMIT
 - PROPOSED SPECIAL ROAD SPEED LIMIT
 - PROPOSED CLEARWAY
 - PROPOSED PROHIBITION OF ENTRY
 - PROPOSED NO THROUGH ROAD
 - EXISTING NO RIGHT TURN
 - PROPOSED STRUCTURE

First Issue	MW	RR	06/12/19	P01
Clearways added.	MW	RR	18/12/19	P02
Revision Details	By	Check	Date	Suffix

Purpose of issue
DCO APPLICATION

Client
Highways England
Floor 5
Two Colonnade Square
38 Colonnade Circus
Birmingham
B4 6BN

Development Consent Order Number
TR010054

Project Title
M54 to M6 Link Road



Development Consent Order Drawing Number
TR010054/APP/2.8

Drawing Title
TRAFFIC REGULATION MEASURES, REGULATION 5(2)(O) SHEET 7 OF 10

Designed	Drawn	Checked	Approved	Date
MW	MW	AM	RR	18/12/19
Internal Project No. 60536736			Suitability	
Scale @ A1 1:2500H/1:2500V			Zone	Development Consent Order

THIS DOCUMENT HAS BEEN PREPARED PURSUANT TO AND SUBJECT TO THE TERMS OF AECOM'S APPOINTMENT BY ITS CLIENT. AECOM ACCEPTS NO LIABILITY FOR ANY USE OF THIS DOCUMENT OTHER THAN BY ITS ORIGINAL CLIENT OR FOLLOWING AECOM'S EXPRESS AGREEMENT TO SUCH USE, AND ONLY FOR THE PURPOSES FOR WHICH IT WAS PREPARED AND PROVIDED.

Drawing Number Highways England PIN HE514465 -ACM	I Originator -DCO-	I Volume Z3 SW_PR_Z	I Type -DR-CH-1507	Rev P02
--	------------------------------	-------------------------------	------------------------------	-------------------

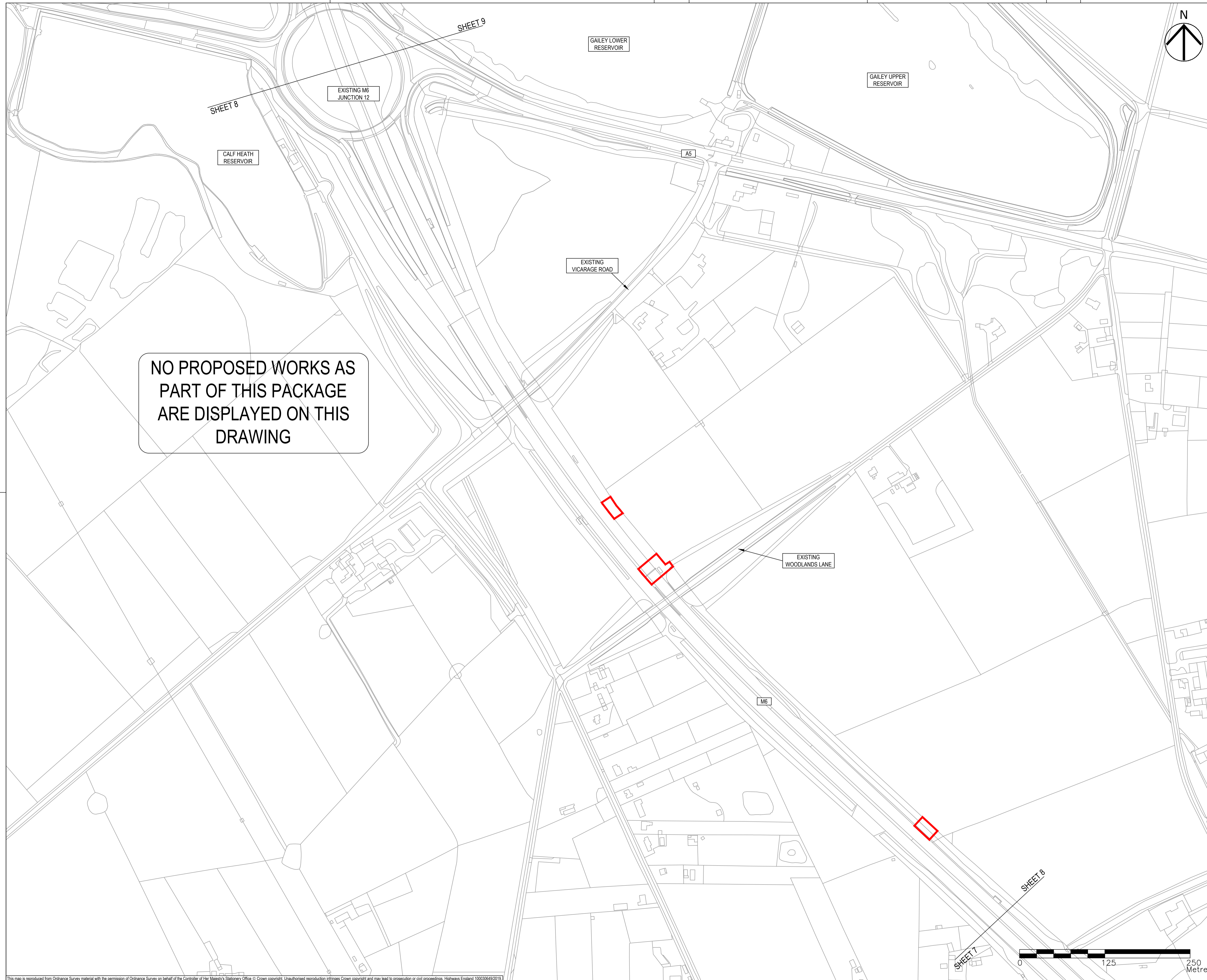

NO PROPOSED WORKS AS PART OF THIS PACKAGE ARE DISPLAYED ON THIS DRAWING

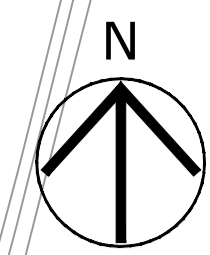

- NOTES**
- THIS DRAWING IS TO BE READ IN CONJUNCTION WITH ALL OTHER RELEVANT DOCUMENTATION.
 - DO NOT SCALE FROM THIS DRAWING. USE ONLY PRINTED DIMENSIONS.
 - ALL DIMENSIONS IN MILLIMETRES. ALL CHAINAGES, LEVELS AND COORDINATES ARE IN METRES UNLESS OTHERWISE DEFINED OTHERWISE.
 - THIS DRAWING IS TO BE READ IN CONJUNCTION WITH THE PROJECT HEALTH & SAFETY FILE FOR ANY IDENTIFIED POTENTIAL RISKS.
 - THE WORKS ARE SHOWN ILLUSTRATIVELY ONLY AND ARE SUBJECT TO CHANGE THROUGH DETAILED DESIGN IN ACCORDANCE WITH THE TERMS OF THE DEVELOPMENT CONSENT ORDER.

- KEY**
- LIMITS OF LAND TO BE ACQUIRED OR USED PERMANENTLY OR TEMPORARILY (THE ORDER LIMITS)
 - LAND NOT INCLUDED WITHIN THE ORDER LIMITS
 - PROPOSED 30mph SPEED LIMIT
 - PROPOSED 40mph SPEED LIMIT
 - PROPOSED 50mph SPEED LIMIT
 - PROPOSED NATIONAL SPEED LIMIT
 - PROPOSED SPECIAL ROAD SPEED LIMIT
 - PROPOSED CLEARWAY
 - PROPOSED PROHIBITION OF ENTRY
 - PROPOSED NO THROUGH ROAD
 - EXISTING NO RIGHT TURN
 - PROPOSED STRUCTURE

First Issue	MW	RR	06/12/19	P01
Clearways added.	MW	RR	18/12/19	P02
	By	Check	Date	Suffix

DCO APPLICATION

Client
Highways England
Floor 5
Two Colonnade Square
38 Colonnade Circus
Birmingham
B4 6BN

Development Consent Order Number
TR010054

Project Title
M54 to M6 Link Road



Development Consent Order Drawing Number
TR010054/APP/2.8

Drawing Title
TRAFFIC REGULATION MEASURES, REGULATION 5(2)(O) SHEET 8 OF 10

Designed	Drawn	Checked	Approved	Date
MW	AM	AM	RR	18/12/19
Internal Project No. 60536736		Suitability S8		
Scale @ A1 1:2500H/1:2500V		Zone Development Consent Order		

THIS DOCUMENT HAS BEEN PREPARED PURSUANT TO AND SUBJECT TO THE TERMS OF AECOM'S APPOINTMENT BY ITS CLIENT. AECOM ACCEPTS NO LIABILITY FOR ANY USE OF THIS DOCUMENT OTHER THAN BY ITS ORIGINAL CLIENT OR FOLLOWING AECOM'S EXPRESS AGREEMENT TO SUCH USE, AND ONLY FOR THE PURPOSES FOR WHICH IT WAS PREPARED AND PROVIDED.

Drawing Number Highways England PIN HE514465 -ACM	I Originator -DCO-	I Volume Z3 SW_PR_Z	I Type -DR-CH-1508	I Number P02
--	------------------------------	-------------------------------	------------------------------	------------------------

This map is reproduced from Ordnance Survey material with the permission of Ordnance Survey on behalf of the Controller of Her Majesty's Stationery Office. © Crown copyright. Unauthorised reproduction infringes Crown copyright and may lead to prosecution or civil proceedings. Highways England 100030649(2019)

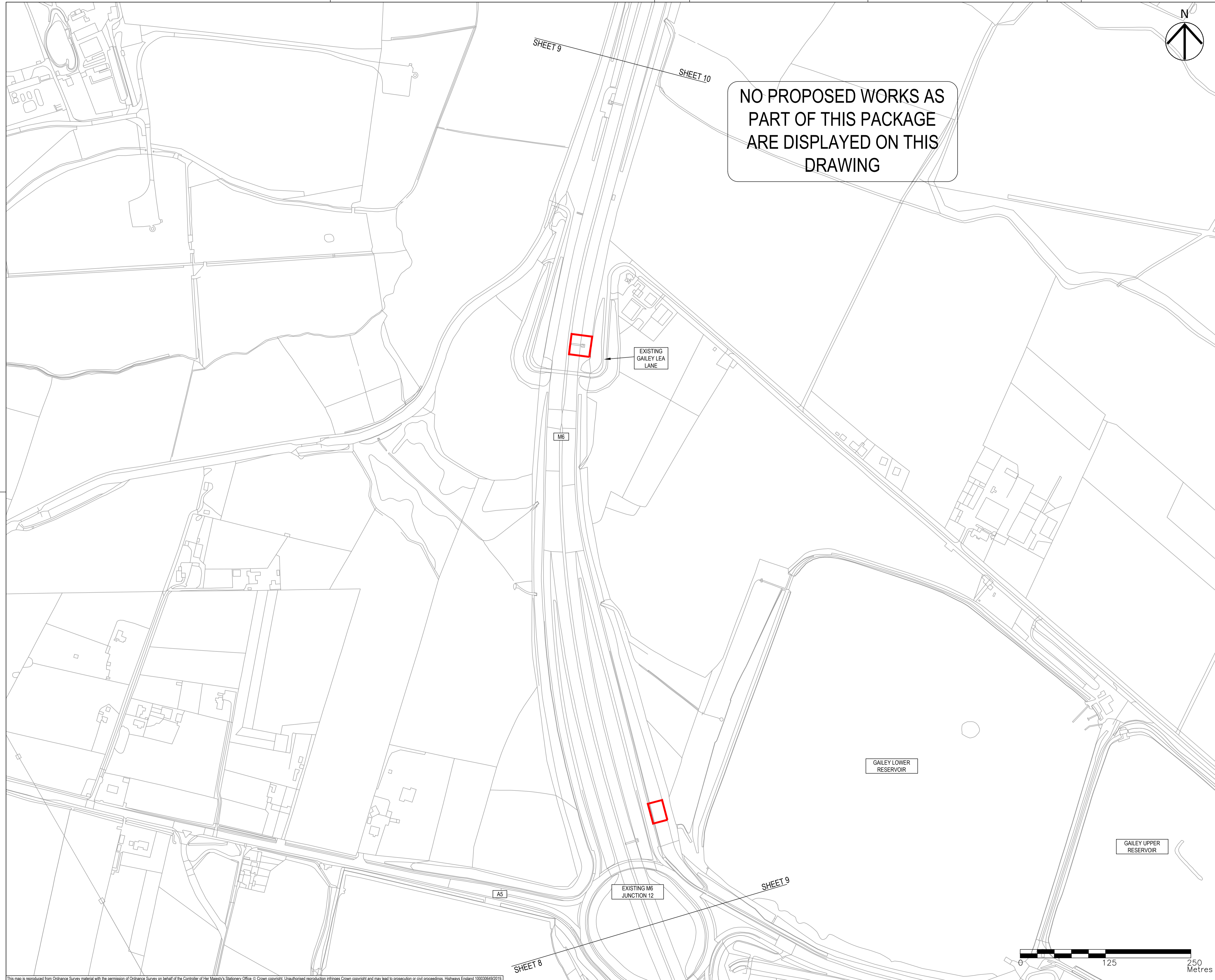

NO PROPOSED WORKS AS
PART OF THIS PACKAGE
ARE DISPLAYED ON THIS
DRAWING

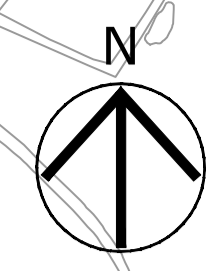

- NOTES**
1. THIS DRAWING IS TO BE READ IN CONJUNCTION WITH ALL OTHER RELEVANT DOCUMENTATION.
 2. DO NOT SCALE FROM THIS DRAWING. USE ONLY PRINTED DIMENSIONS.
 3. ALL DIMENSIONS IN MILLIMETRES. ALL CHAINAGES, LEVELS AND COORDINATES ARE IN METRES UNLESS DEFINED OTHERWISE.
 4. THIS DRAWING IS TO BE READ IN CONJUNCTION WITH THE PROJECT HEALTH & SAFETY FILE FOR ANY IDENTIFIED POTENTIAL RISKS.
 5. THE WORKS ARE SHOWN ILLUSTRATIVELY ONLY AND ARE SUBJECT TO CHANGE THROUGH DETAILED DESIGN IN ACCORDANCE WITH THE TERMS OF THE DEVELOPMENT CONSENT ORDER.

- KEY**
- LIMITS OF LAND TO BE ACQUIRED OR USED PERMANENTLY OR TEMPORARILY (THE ORDER LIMITS)
 - LAND NOT INCLUDED WITHIN THE ORDER LIMITS
 - PROPOSED 30mph SPEED LIMIT
 - PROPOSED 40mph SPEED LIMIT
 - PROPOSED 50mph SPEED LIMIT
 - PROPOSED NATIONAL SPEED LIMIT
 - PROPOSED SPECIAL ROAD SPEED LIMIT
 - x PROPOSED CLEARWAY
 - PROPOSED PROHIBITION OF ENTRY
 - PROPOSED NO THROUGH ROAD
 - EXISTING NO RIGHT TURN
 - PROPOSED STRUCTURE

First Issue	MW	RR	06/12/19	P01
Clearways added.	MW	RR	18/12/19	P02
Revision Details	By	Check	Date	Suffix

DCO APPLICATION

Client
Highways England
Floor 5
Two Colmore Square
38 Colmore Circus
Birmingham
B4 6BN



Development Consent Order Number
TR010054

Project Title
M54 to M6 Link Road

Development Consent Order Drawing Number
TR010054/APP/2.8

**TRAFFIC REGULATION
MEASURES,
REGULATION 5(2)(O)
SHEET 9 OF 10**

Designed MW	Drawn MW	Checked AM	Approved RR	Date 18/12/19
Internal Project No. 60536736			Suitability S8	
Scale @ A1 1:2500H/1:2500V			Zone Development Consent Order	

THIS DOCUMENT HAS BEEN PREPARED PURSUANT TO AND SUBJECT TO THE TERMS OF AECOM'S APPOINTMENT BY ITS CLIENT. AECOM ACCEPTS NO LIABILITY FOR ANY USE OF THIS DOCUMENT OTHER THAN BY ITS ORIGINAL CLIENT OR FOLLOWING AECOM'S EXPRESS AGREEMENT TO SUCH USE, AND ONLY FOR THE PURPOSES FOR WHICH IT WAS PREPARED AND PROVIDED.

Drawing Number HE514465	Highways England PIN -ACM	I Originator -DCO-	I Volume -DR-CH-1509	Rev P02
Location Z3 SW_PR_Z		I Type I Role I Number		

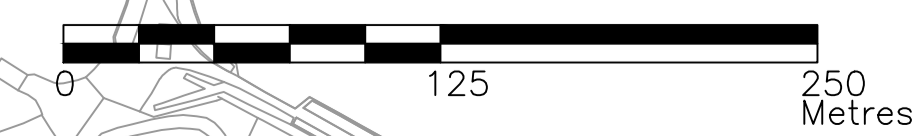

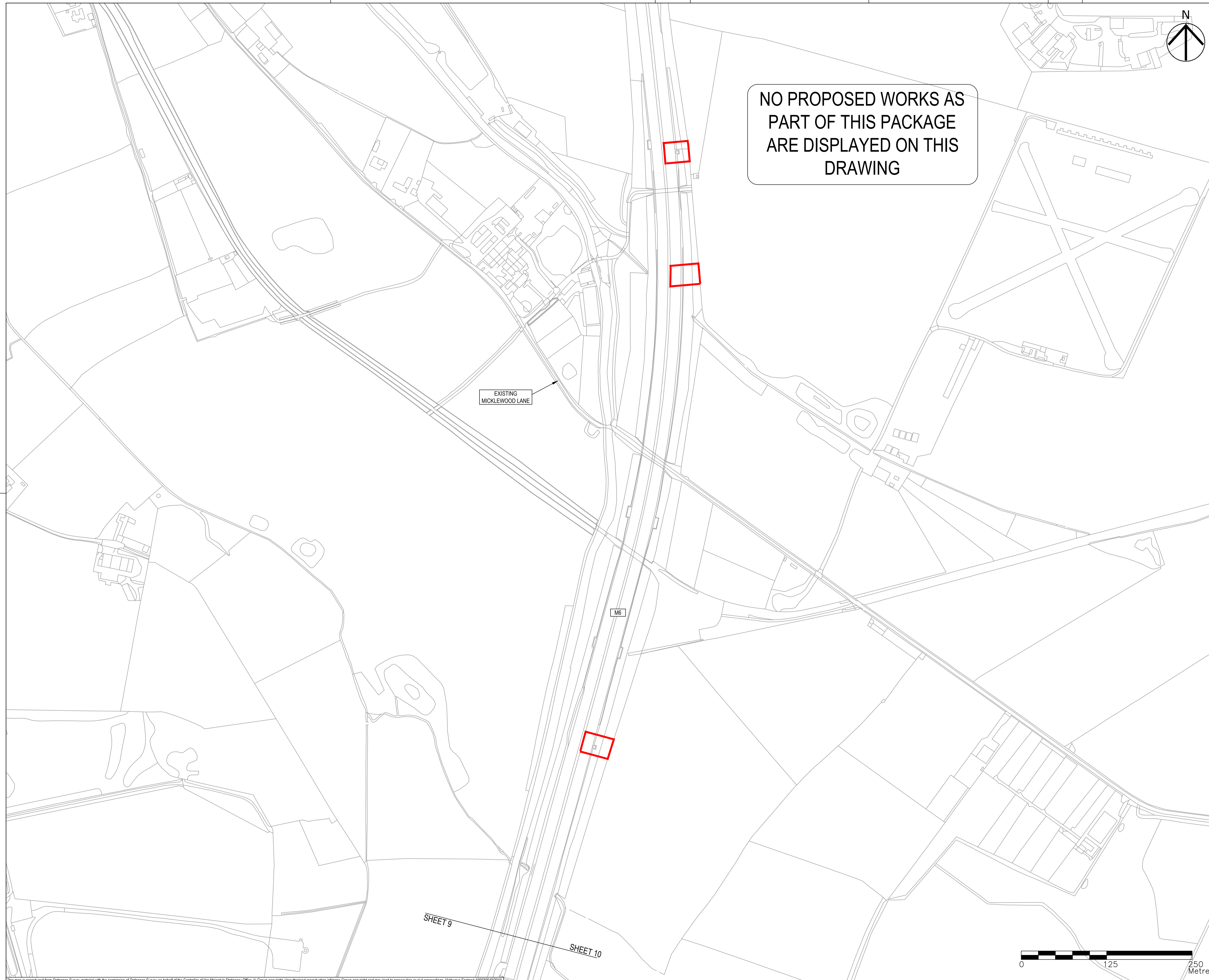

NO PROPOSED WORKS AS PART OF THIS PACKAGE ARE DISPLAYED ON THIS DRAWING

EXISTING MICKLEWOOD LANE

M6

SHEET 9

SHEET 10

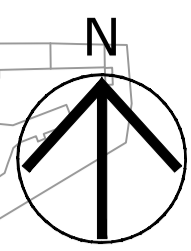

- NOTES
1. THIS DRAWING IS TO BE READ IN CONJUNCTION WITH ALL OTHER RELEVANT DOCUMENTATION.
 2. DO NOT SCALE FROM THIS DRAWING. USE ONLY PRINTED DIMENSIONS.
 3. ALL DIMENSIONS IN MILLIMETRES. ALL CHAINAGES, LEVELS AND COORDINATES ARE IN METRES UNLESS DEFINED OTHERWISE.
 4. THIS DRAWING IS TO BE READ IN CONJUNCTION WITH THE PROJECT HEALTH & SAFETY FILE FOR ANY IDENTIFIED POTENTIAL RISKS.
 5. THE WORKS ARE SHOWN ILLUSTRATIVELY ONLY AND ARE SUBJECT TO CHANGE THROUGH DETAILED DESIGN IN ACCORDANCE WITH THE TERMS OF THE DEVELOPMENT CONSENT ORDER.

- KEY
- LIMITS OF LAND TO BE ACQUIRED OR USED PERMANENTLY OR TEMPORARILY (THE ORDER LIMITS)
 - LAND NOT INCLUDED WITHIN THE ORDER LIMITS
 - PROPOSED 30mph SPEED LIMIT
 - PROPOSED 40mph SPEED LIMIT
 - PROPOSED 50mph SPEED LIMIT
 - PROPOSED NATIONAL SPEED LIMIT
 - PROPOSED SPECIAL ROAD SPEED LIMIT
 - × × PROPOSED CLEARWAY
 - PROPOSED PROHIBITION OF ENTRY
 - PROPOSED NO THROUGH ROAD
 - EXISTING NO RIGHT TURN
 - PROPOSED STRUCTURE

First Issue	MW	RR	06/12/19	P01
Clearways added.	MW	RR	18/12/19	P02
Revision Details	By	Check	Date	Suffix

Purpose of issue
DCO APPLICATION

Client
Highways England
Floor 5
Two Colonnade Square
38 Colonnade Circus
Birmingham
B4 6BN



Development Consent Order Number
TR010054

Project Title
M54 to M6 Link Road

Development Consent Order Drawing Number
TR010054/APP/2.8

Drawing Title
TRAFFIC REGULATION MEASURES, REGULATION 5(2)(O) SHEET 10 OF 10

Designed	Drawn	Checked	Approved	Date
MW	MW	AM	RR	18/12/19
Internal Project No.	Suitability			
60536736	S8			
Scale @ A1	Zone			
1:2500H/1:2500V	Development Consent Order			

THIS DOCUMENT HAS BEEN PREPARED PURSUANT TO AND SUBJECT TO THE TERMS OF AECOM'S APPOINTMENT BY ITS CLIENT. AECOM ACCEPTS NO LIABILITY FOR ANY USE OF THIS DOCUMENT OTHER THAN BY ITS ORIGINAL CLIENT OR FOLLOWING AECOM'S EXPRESS AGREEMENT TO SUCH USE, AND ONLY FOR THE PURPOSES FOR WHICH IT WAS PREPARED AND PROVIDED.

Drawing Number	Highways England PIN	I Originator	I Volume	Rev
HE514465	-ACM	-DCO-		P02
Z3 SW_PR_Z		-DR-CH-1510		
Location	I Type	I Role	I Number	

